



THORO®

Waterproofing of basements

Problem description

Below grade structures are used today for several functions. Basements are not longer used just as storage space, but nowadays find their use as living, working or parking space.

This means that the comfort of basements, and especially the water tightness are very critical. The functionality of the rooms is no longer guaranteed when water penetrates, and thus the value of the building is strongly reduced.

The application of waterproofing systems on the external face of the structure, during the construction phase of the basement, is recommended as the repair of basements by internal application of waterproofing products requires special products and skilled workers.

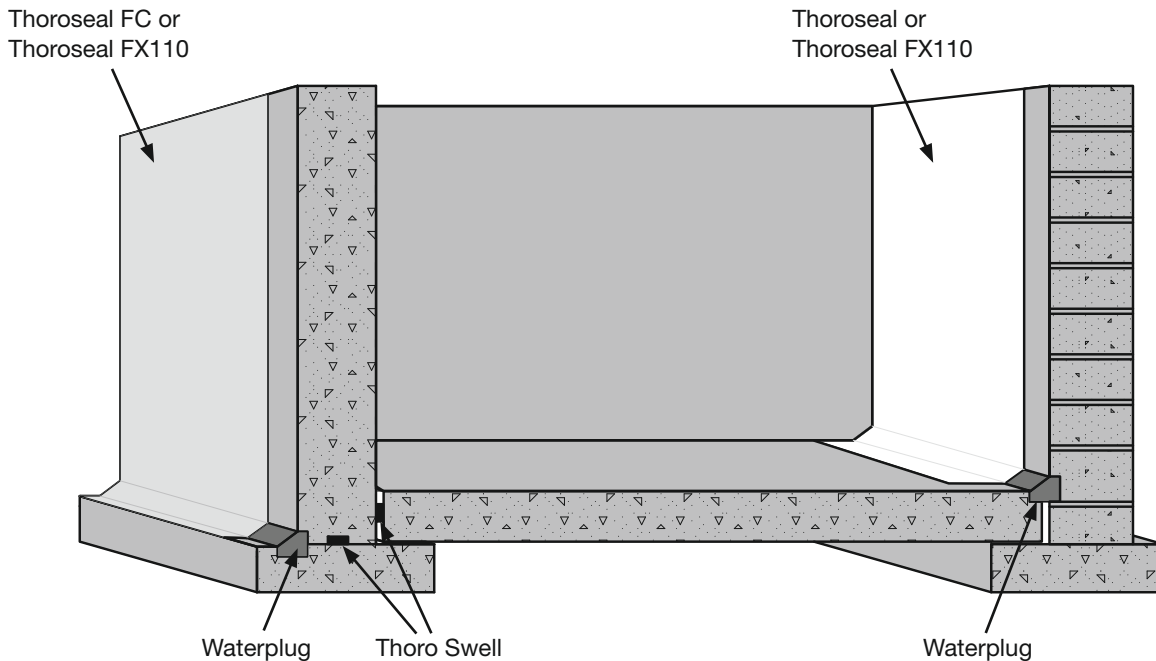

Objective

- Seal and protect basement walls against the ingress of water, using a continuous membrane that can be in direct contact with the soil and resists positive water pressures. The material must resist to mechanical damages during soil filling operations.
- Waterproof the inside of basements, as repair, using a cementitious membrane that resists negative water pressure.
- Joints and other penetration points have to specially treated to ensure effectiveness of the system, and thus waterproofing of the structure.
- EN 1504-2 certified products will offer additional protection and warranty.

THOROSEAL® THOROSEAL® FC

Thoroseal is a cement-based coating for waterproofing the inside of basements, built in concrete or concrete blocks. Thoroseal white is ideally suited to make your basements a nice living or working space.

Thoroseal FC is the cement-based waterproofing coating, specifically used on the outside of below grade structures to protect them against water ingress.

Both materials are waterproof, but at the same time highly water vapour permeable.

Main features	Main benefits
Waterproof up to ≥ 4 bar	Can be applied in deep applications exposed to high water pressures
Applied in only 2 mm thickness	No loss of working space No extra excavation required
Can be brush or spray applied	Economic application, reduced labour costs in big surfaces



THORO® SWELL

Thoro Swell are hydroswellable gaskets on polyurethane basis. The material is available out of the cartridge, Thoro Swell Paste, and as bandages, Thoro Swell Strip.

Main features	Main benefits
Permanent hydroswellable capacities	No loss of swelling capacity over dry/wet cycling
High volume expansion	Permanent waterseal
Easy installation	Economic application, reduced labour costs

WATERPLUG®

Waterplug is an ultra-fast setting plugging mortar.

The product is used for stopping active water leakages, and for sealing the kicker-joints. It allows immediate application of the waterproofing slurry, reducing downtimes at the jobsite.

Main features	Main benefits
Ultra-fast setting and hardening	Stops leakages immediately No downtimes
Cement-based	Perfect compatibility with substrate and consequent waterproofing slurry
Expansive	Permanently waterproof



THOROSEAL® FX110

Thoroseal FX 110 is an elastomeric, cement-based waterproofing coating for concrete and masonry walls. It is ideally suited for waterproofing structures exposed to movements or prone to cracking.

The product resists positive and negative water pressure, and reveals good water vapour permeability.

Main features	Main benefits
Waterproof up to 1.0 bar (negative pressure)	Can be used in deep applications
Static and dynamic crack bridging	Waterproof even in case of open/opening cracks
Can be brush or spray applied	Economic application, reduced labour costs in big surfaces



Welcome to the world of Thoro®

Thoro offers innovative and job specific solutions for the construction industry. Since 1912, and with almost 100 years of experience in waterproofing and concrete repair, Thoro has the know-how to provide the right solution for your problem. Thoro products are universally approved by internationally recognized test institutes, while the Thoro production unit in Mol, Belgium is certified under EN ISO9001 and EN ISO14001.



Thoro® offers:

Thorseal® – cementitious waterproofing products

Waterplug® – fast setting cementitious waterstop

Thoro® Swell – hydroswellable gaskets

Thoro® Acryl 60 – acrylic bonding agent

Thoro® Structurite – concrete repair mortars

Thoro® Crete – horizontal concrete repair mortars

Thoro® Lastic – elastomeric protective coatings

Thoro® Enviroseal – water repellents

Thoro® Grout – cementitious precision grouts

Thoro:

BASF Construction Chemicals Belgium NV
Nijverheidsweg 89
B-3945 Ham
www.thoro.com
Tel. +32 11 34 04 32
Fax +32 14 81 32 10

B.T.W./T.V.A. BE 0417.791.569
RPR/RPM Hasselt

Your Thoro distributor: